



**NL**

EEN NEDERLANDSE VERSIE VAN DEZE HANDLEIDING IS BESCHIKBAAR OP DE WEBSITE  
[WWW.PAWZZ.FR](http://WWW.PAWZZ.FR)

**ES**

UNA VERSIÓN EN ESPAÑOL DE ESTE MANUAL ESTÁ DISPONIBLE EN EL SITIO WEB  
[WWW.PAWZZ.FR](http://WWW.PAWZZ.FR)



# Smart cat litter box

## User manual

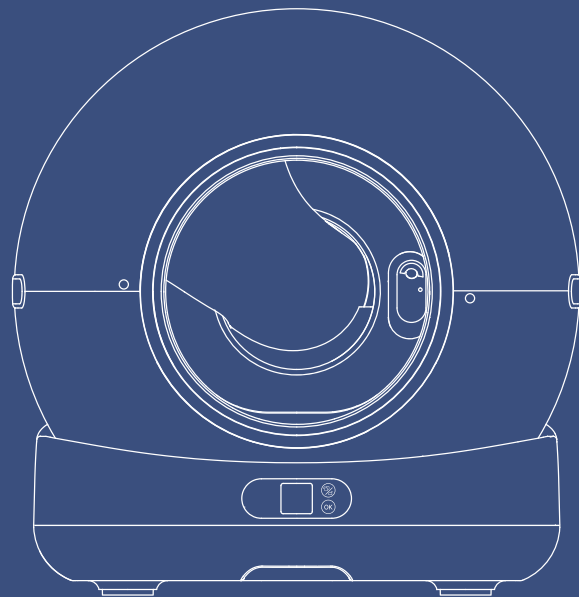

CLB100WT

# CONTENTS

I	PRODUCT DESCRIPTION .....	03
II	QUICK START GUIDE .....	06
III	CONTROL PANEL OVERVIEW.....	10
IV	APP CONNECTION & SETUP .....	12
V	OPERATING INSTRUCTIONS .....	16
VI	MAINTENANCE & CLEANING .....	29
VII	TROUBLESHOOTING .....	31
VIII	FAQ.....	32
IX	PRODUCT SPECIFICATIONS.....	33
X.	DISPOSAL .....	34
XI.	ABOUT THIS MANUAL.....	34
XII.	EU DECLARATION OF CONFORMITY .....	35

## Important Safety Instructions

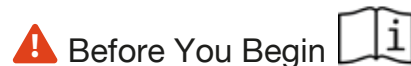

Please read these safety instructions carefully before using your Smart Cat Litter Box.

### Safety Guidelines

#### 1. Installation & Usage:

- Follow the installation instructions carefully
- Indoor use only - keep away from direct sunlight and rain
- Place on a level, stable surface

#### 2. Location & Placement:

- Choose a well-ventilated area
- Keep away from water sources
- Do not place objects on top of the device

#### 3. Weight & Capacity

- Kittens weighing less than 1kg and lactating cats should not use the auto cleaning mode of the device.
- Do not exceed recommended litter capacity
- Keep children from climbing or sitting on the device

#### 4. Power & Electrical Safety

- Use only the provided power adapter
- Keep the power cord away from heated surfaces
- Unplug during maintenance or when not in use
- Do not operate with a damaged cord or plug

#### 5. Maintenance & Care

- Unplug before cleaning or servicing
- Do not immerse in water
- Use only original replacement parts
- Regular cleaning is required for optimal performance

#### 6. General Precautions

- Supervise your pet during initial use
- Keep packaging materials away from children and pets
- Contact customer service if you encounter any issues

### Important Notes

- Proper maintenance ensures optimal performance and longevity.
- Please read this manual carefully before. Once installed and used, it means that you have carefully read and accepted the following safety instructions.
- If the product does not work properly due to other unknown conditions, and you do not have time to refer to the instructions, please restart the power.

# I. PRODUCT DESCRIPTION

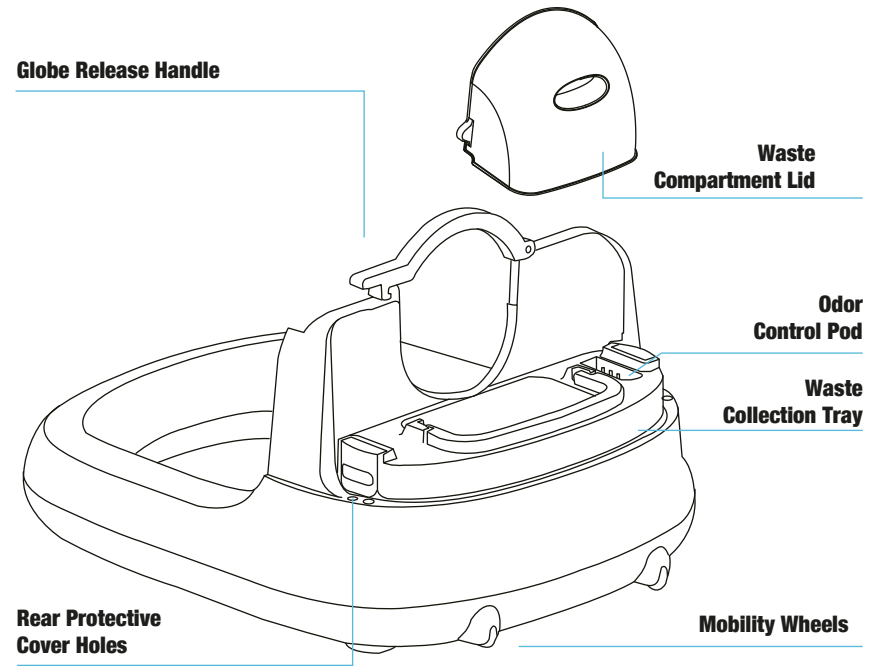
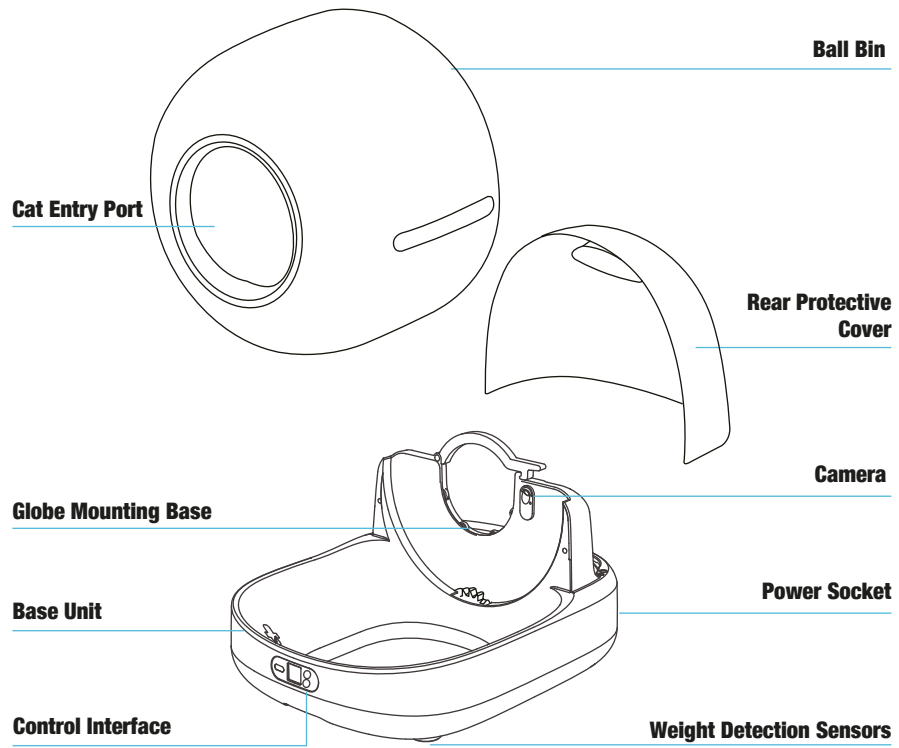

## Package Contents

### 1.2 Accessories (in litter storage box):

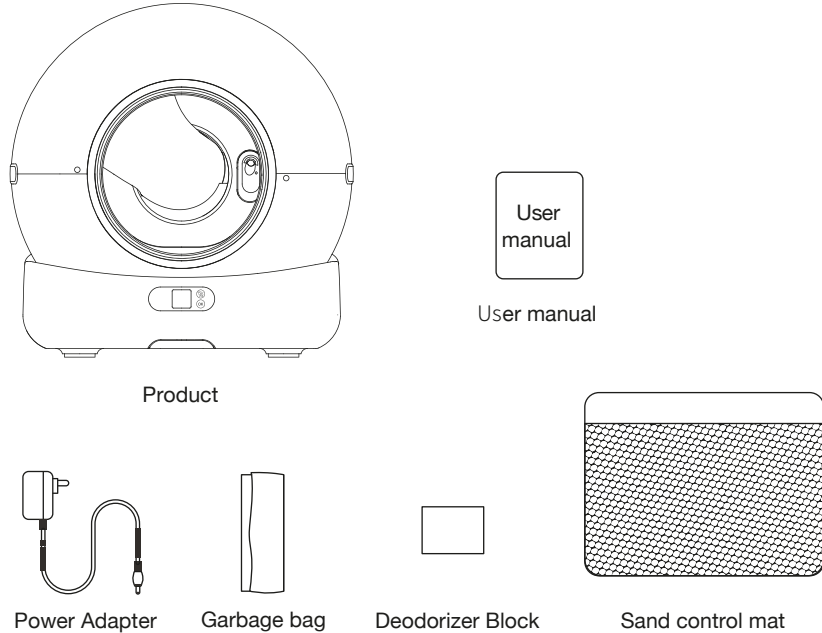

#### Notice:

Please follow the installation steps, including garbage bags and deodorizer.

## II. QUICK START GUIDE

### 2.1 Open the box:

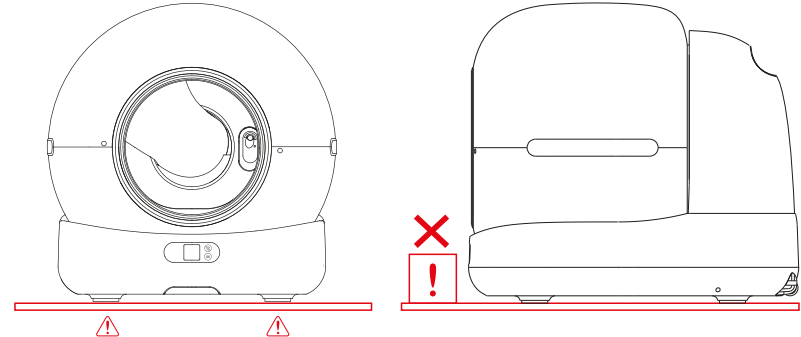

- ① Open the box, take out the protective elements on both sides.
- ② Take out the PE bag and the product.
- ③ Tear off all the traceless tapes on the product.

**2.2** Please place the machine on a firm and flat ground. Please make sure ball bin & waste bin(include garbage bag) properly install, then put on protective cover.



**2.3** Please power on the device and do self-checking. There will be no indicators if self-checking is well done.

**2.4** Please fill litter no exceed "Max Line", Use  button to select  icon and press  button to calibrate the weight.

**2.5** Use  to select the  icon, then press and hold  for 5 seconds until the WiFi icon blinks. Then start the connection process.

## 2.6 Installation Steps:

- ① Fit the trash bag into the bin and assemble it properly before placing it on the product base.
- ② Insert the deodorizer block.
- ③ Place the ball bin in its designated position and lower the locking handle.

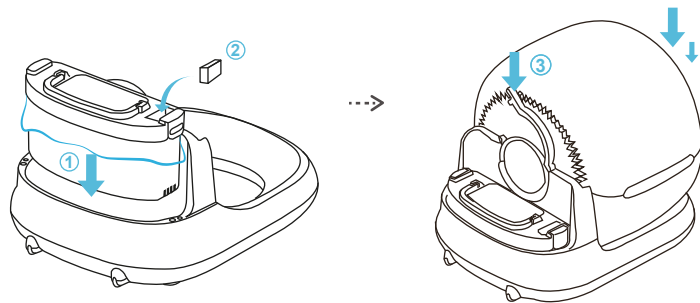

- ④ Place the waste compartment lid onto the trash bin.
- ⑤ Put on the rear protective cover.

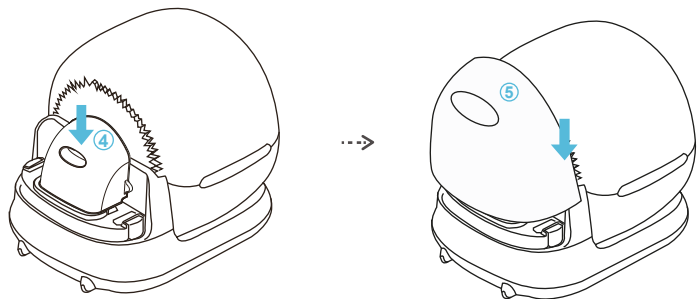

## 2.7 Use:

2.7.1 Power on the device, it will take time to do self-checking. (When powered on, the barrel compartment rotates for a self-check and resets to its default position.)

2.7.2 The device will automatically be in the state of smart sensing after self-check, no need to change its program.

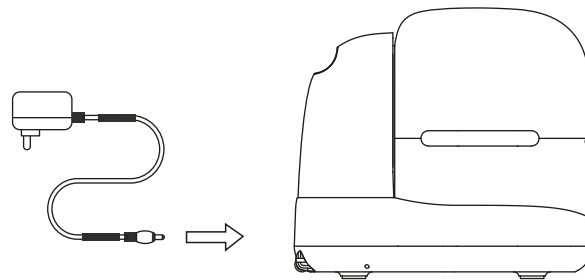

### Notice:

Don't pick up or drag the product after powering up (This would interfere with weight calibration in the reset program).

During the cleaning process, all keys are suspended. If you need to perform other functions, please wait until the clearing process is complete.

## 2.8 Sands filling:

Make sure the litter does not exceed the "MAX" line. (The amount of sand can be adjusted according to the actual situation.)

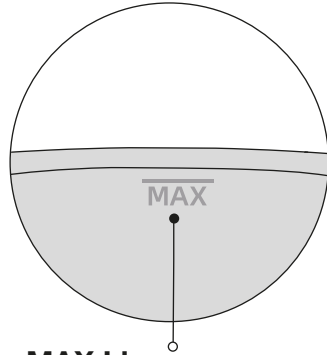
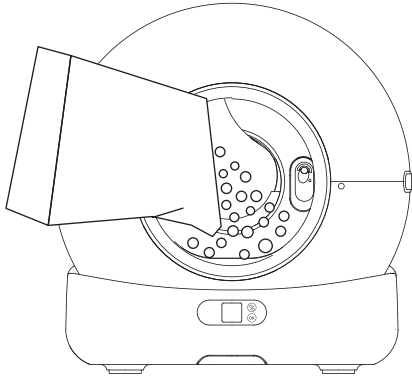

### MAX Line

The amount of cat litter should not exceed Max line



### Notice:

After adding cat litter, the "Pet Entered"  icon will appear. Use the " mode switch"  icon key to select the "Weight Calibration"  icon, then press the OK  button briefly to perform the weight calibration.

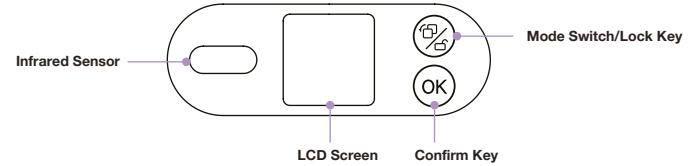
## III. CONTROL PANEL OVERVIEW













### Key Functions:

-  Mode Switch Key: Short press to switch modes.  
Lock: Press and hold for 5 seconds to lock.  
Unlock: While locked, press and hold for 5 seconds to unlock.
-  Confirm Key: Confirm in the selected mode.

### LCD Screen:

- When the function button is active, a warning icon will appear if an object is detected nearby.
- Icons remain steady when selected and flash while performing specific tasks.

## Screen Icon Description

	Name	icon	Method	Description
Function Icon	WiFi		Flashing	WiFi not connected, select the WiFi icon and press and hold the OK button for 5 seconds to connect. Reset the product information and start the APP connection process
			Stable	WiFi connection is successful.
	Smooth Sand		Flashing	Use the mode switch icon key to select the Smooth Sand icon, then press the OK button briefly to perform smoothing.
	Manual Clean		Flashing	Use the mode switch icon key to select the Manual Clean icon, then press the OK button briefly to start cleaning.
	Pour Sand		Flashing	Use the mode switch icon key to select the Pour Sand icon, then press and hold the OK button for 5 seconds to empty the litter.
Warning Icon	Weight Calibration		Flashing	Use the mode switch icon key to select the Weight Calibration icon, then press the OK button briefly to perform weight calibration (recommended after adding or replacing cat litter).
	Pet Entered		Stable	Icon reminder after the pet enters or when cat litter is added.
	Object Nearby		Stable	Alerts you when something approaches the device.
	Waste Bin Full		Stable	Reminds you to replace the trash bag when the waste bin is full.
	Rear Protective Cover Not Secured		Stable	Alerts you if the rear cover is not properly secured.
Do Not Disturb Mode		Stable	Indicates the device is in Do Not Disturb mode.	

### Notice:

- When a function icon is selected and running, press the OK button briefly to cancel the current task.
- For the smooth, clean, and empty litter functions, the task cannot be canceled once it has progressed beyond a certain point.

## IV. APP CONNECTION

### 4.1 App download

- ① You can download “Smart life” or “Tuya smart” in App store and Google Play.
- ② Or you can scan the below 2 QR codes.



Smart life





Tuya smart

### 4.2 Network connection

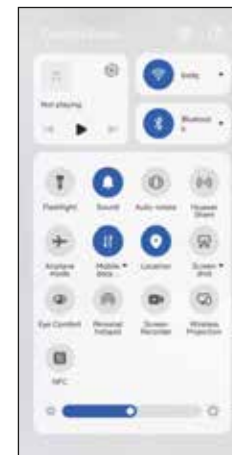
4.2.1 Confirm that the phone is connected to 2.4GHz or 5GHz WiFi network, then turn on Bluetooth and Location.



4.2.2 Press the "Mode Switch" button  to select the WiFi icon , then press and hold the OK button  for 5 seconds to connect to WiFi (this is also the same process for resetting WiFi).



4.2.3 Open your phone App to add device by Bluetooth or WiFi.

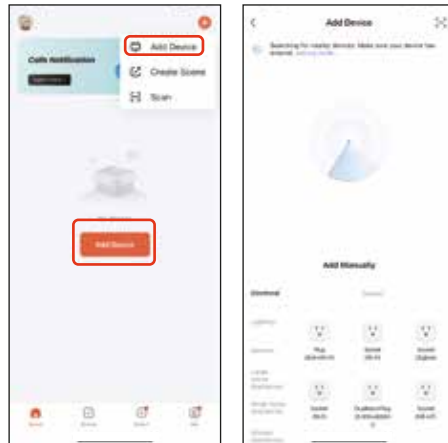

4.2.4 If your phone has the Bluetooth activated, the cat litter shall appear on the screen. Just click on the picture to start the installation.

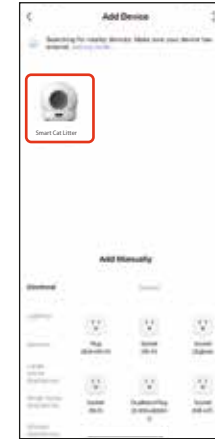

4.2.5 Click on "Next" after inputting WiFi code if asked and wait for the connection.





4.2.6 Click on “Done” when the litter box is connected and open the App to start the operations.

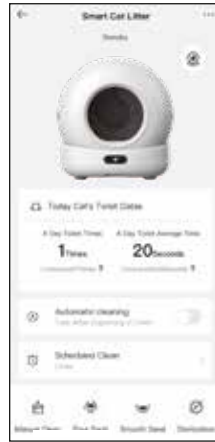

## Notice:

If the network configuration fails or a timeout message is displayed, check the following possibilities:

1. Whether WiFi, Bluetooth, and Location switch are enabled at the same time.
2. Whether the WiFi indicator on the panel is flashing during network configuration.
3. Whether the WiFi network in your home is faulty or down, please check whether other devices can use the network normally.
4. Whether the WiFi password is correct.
5. Whether the WiFi signal is too bad, please move the machine to a nearby router and reconnect.
6. The router connects to many wireless devices, causing IP address conflicts.

## V. OPERATING INSTRUCTIONS

### 5.1 Clean

Tap the "Manual Clean" option in the app or select the cleaning  icon in the product to start cleaning.

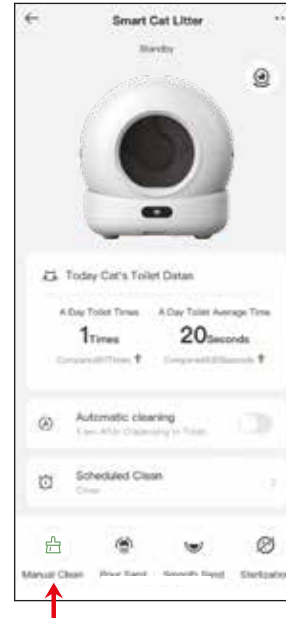

### Notice:

- ① During the cleaning process, you cannot implement other functions; you have to wait until the cleaning process is completed.
- ② During cleaning, you can cancel it by short-pressing the “Manual Clean” button in the app again. When the cleaning icon on the product is flashing, press the OK button briefly to cancel the cleaning process.

(Note: If the cleaning process has progressed to a certain point, it cannot be canceled and you must wait for the cleaning to complete before proceeding to the next step.)

## 5.2 Replace the litter



- 1/ Replace the garbage bag with an empty one (to avoid that the original one is already full of litters);
- 2/ Make sure the remaining sand is almost used out (to avoid spillage when sands pouring).
- 3/ Press the “Sand Pour” button and wait for the machine to clear the remaining litter.
- 4/ Replace the garbage bag with an empty one again after clearing sand.

### Notice:

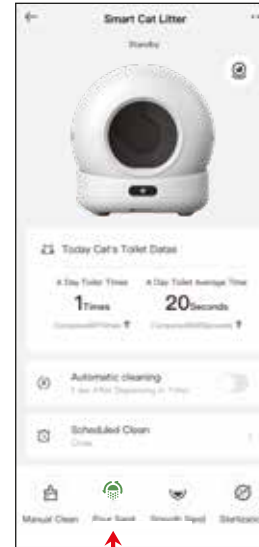
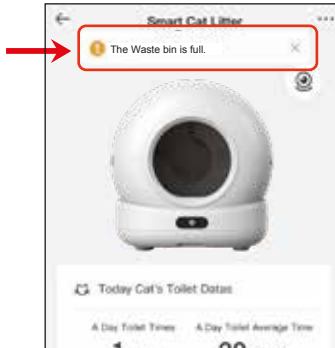
- ① Under "Pour sand" to clean to replace filter, if you already operated wrongly or forgot to replace new bag, you can click the "Pour sand" at once.
- ② When the waste bin is full, the LCD screen will display the "Waste Bin Full" warning icon, and the app will send you a notification.



## 5.2 Add cat litter

After adding cat litter, use the "Mode Switch" button  to select "Weight Calibration" , then press the OK button  briefly to recalibrate the weight.

### Notice:

- ① This device has a protective function during operation. During cleanup, it will stop as soon as the cat is approaching the entrance or the cat litter box feels the weight.
- ② After filling sands, please ensure that the liter of sands does not exceed the MAX line to avoid overflow when pouring the litter.
- ③ Please ensure even distribution of the litter when pouring, avoiding piles near the entrance.
- ④ You can adjust the surface of the cat litter by using the "Smooth Sand" button in the app or selecting the "  " icon on the product.

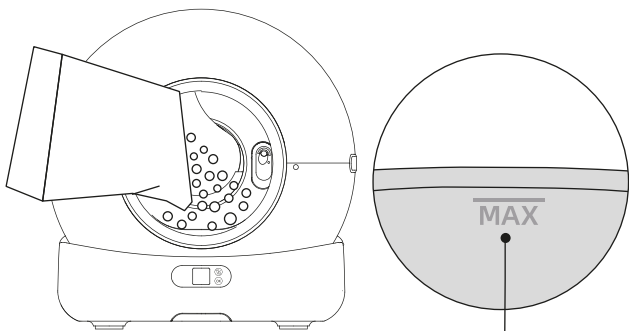
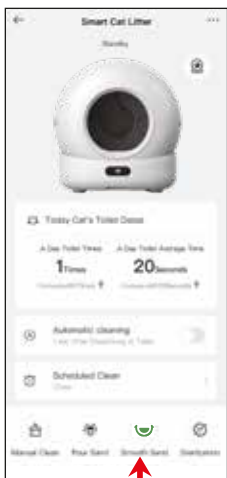

**MAX Line**  
The amount of cat litter should not exceed Max line

## 5.4 Healthy Sterilizations:

- ① One-key sterilizations: 30minutes-working and automatically stop.
- ② Sterilizations Schedule setting: Time /duration.

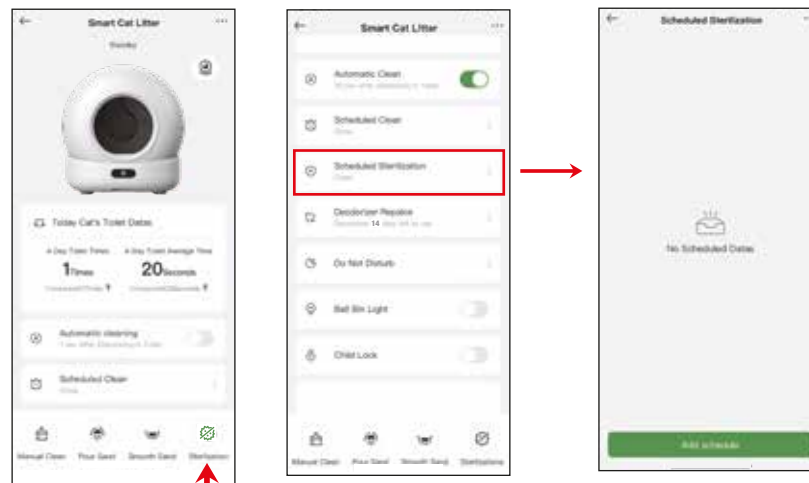

### Notice:

- ① Turn on the UV sterilization function, and it will automatically turn off after the sterilization time reaches about 30 minutes.
- ② It will stop automatically once cat enters in, continue to work after cat leave.

## 5.5 Video Interface Description

5.5.1 Tap the camera icon  on the interface to enter the video view of the pet litter box.

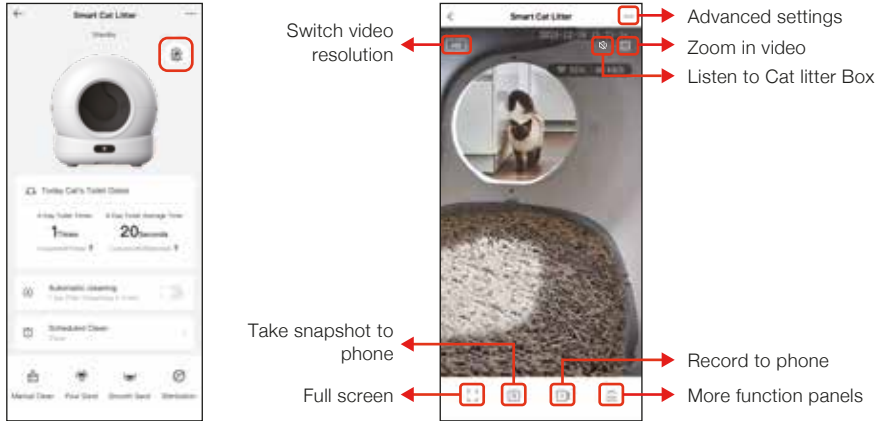

### Notice:

To enable certain functions, the App needs to obtain corresponding permissions on the phone. Please allow them when prompted.

5.5.2 On the live video page, open the function panel to view the various function buttons.

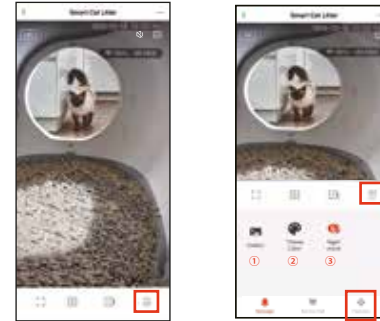

- ① Save photos and videos.
- ② Change the app panel color (Day/Night mode).
- ③ Toggle the camera's night vision mode.

5.5.3 In the message interface, you can view screenshots of your pet using the litter box.

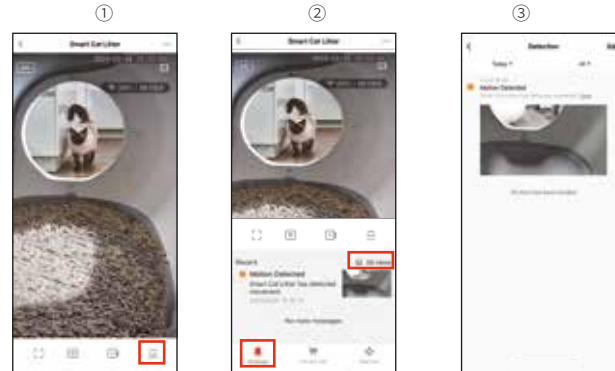

## 5.6 Automatic Clean:

Click“Automatic Clean”on device panel or App. The device will automatically detect the cats in and out. (It will start automatically after the device is powered on and self-checking).

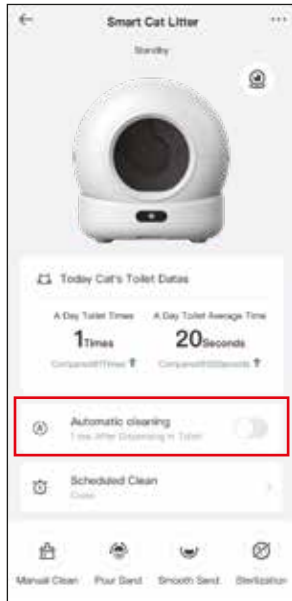

### Notice:

- ① If the kitten weighs less than 1 kg or is pregnant, please turn off the auto-cleaning on the APP, then click “ Manual Clean” according to the actual situation.
- ② If you are using litter that clumps quickly, you can go to Automatic Clean,and enter to set up the “Shovel Poop Delay Time”, then the device will wait for time after pets dispensing in toilet. such as 1 minute, to clean the litter as quickly as possible and reduce the smell.
- ③ If the cat enters the bin for more than 10 seconds, the cat is judged to have potty behavior.
- ④ If the button on the App can't be controlled and synchronized with the panel buttons temporarily, please check the network status or re-configure the network, or click the buttons on the App and repeat once or twice.

## 5.7 Schedule Clean:

Put up a clean schedule according to needs. Daily routine cleaning.

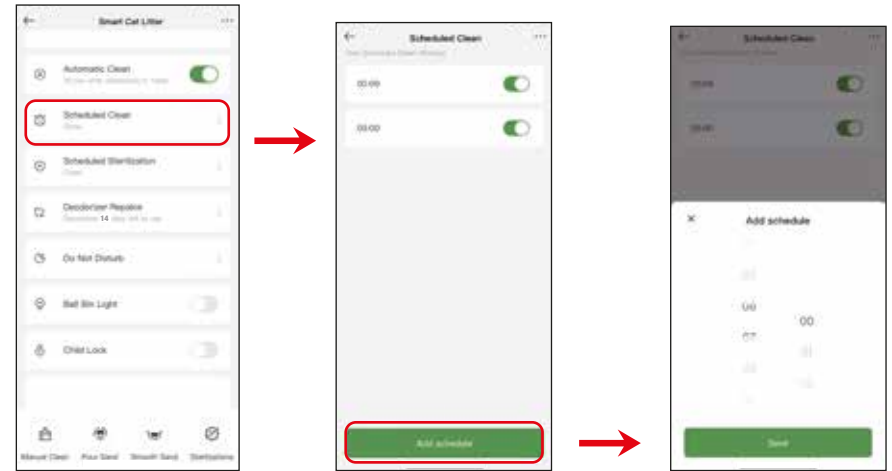

### Notice:

If there is an overlap with Do Not Disturb Mode, the device will do cleaning (not sterilised) and enter Do Not Disturb Mode again.

## 5.8 Deodorizer Replacement:

To check how long the Deodorizer has been used and the valid time for it.

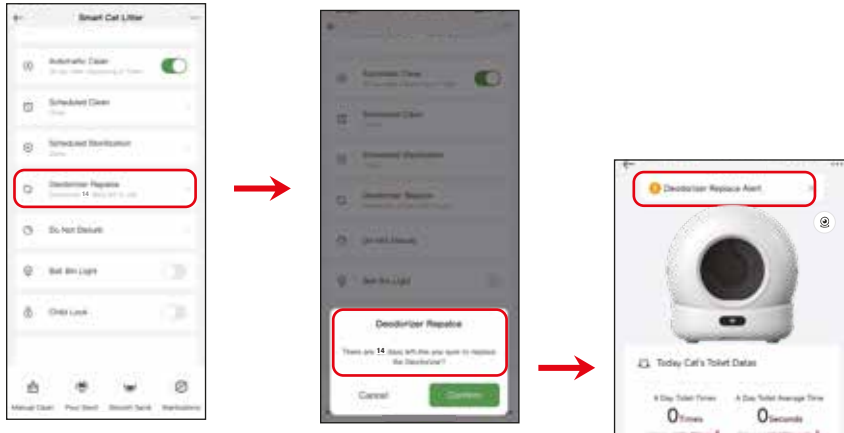

## 5.9 Sleep mode:

When cat litter box is placed in the bedroom, you can set in the App “Do not Disturb” to prevent the night-time activation from disturbing sleep.

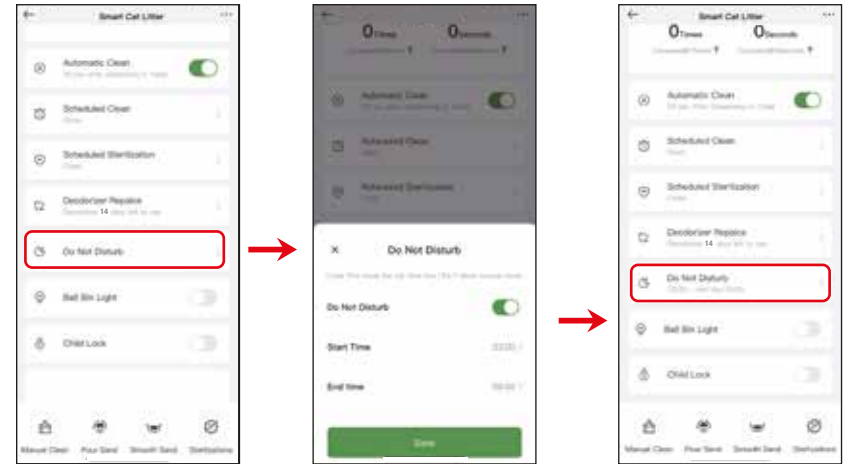

### Notice:

Under Do Not Disturb mode, only support Manual Button Operation.

## 5.10 Ball Bin Light and Child Lock:

- ① Click “Child Lock” on the APP to turn it on or off. Or long press the “Sand Pouring” for 5 seconds to unlock the child lock.
- ② Ball Bin Light: You can turn on the light to check the inside of the ball bin in the night time.

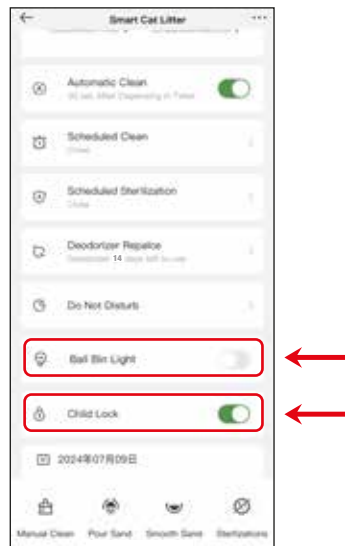

### Notice:

Child lock mode is only applicable to device front panel buttons.

## 5.11 Toilet Statistics:

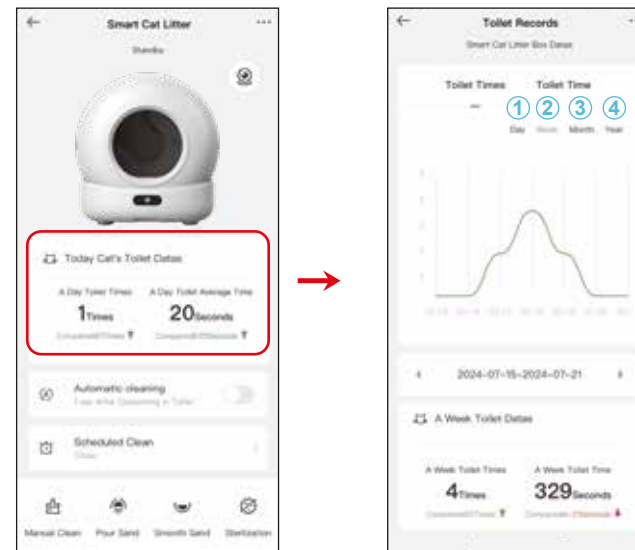

- ① Day: Check the toilet statistics of the 24 hours of a day.
- ② Week: Check the toilet statistics of a week.
- ③ Month: Check the toilet statistics every day of a month.
- ④ Year: Toilet statistics for each month of a year.

## VI. MAINTENANCE & CLEANING

When the LCD screen displays the  icon, or APP msg push “the waste bin is full”, you need to change the waste bag.

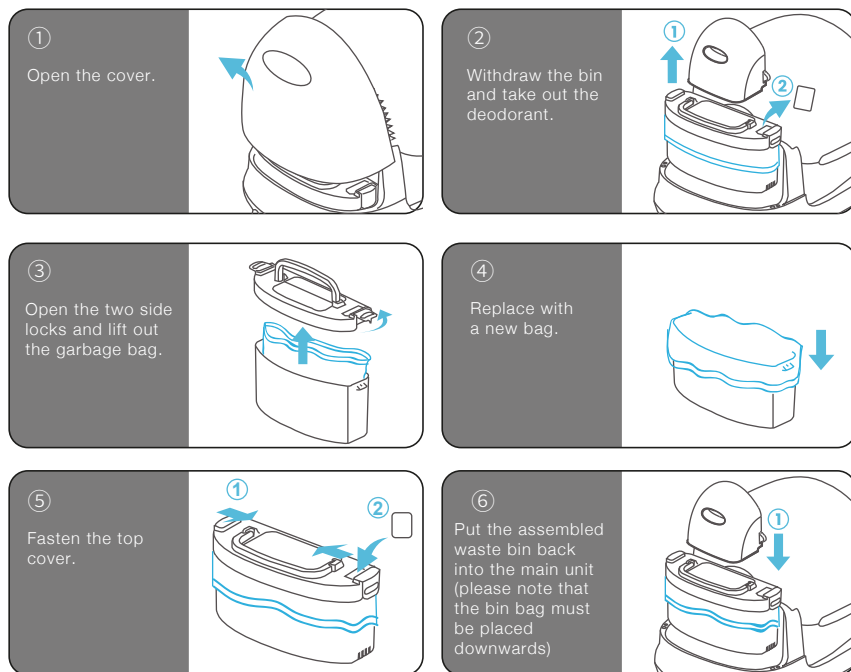

### 6.2 Wash the bin

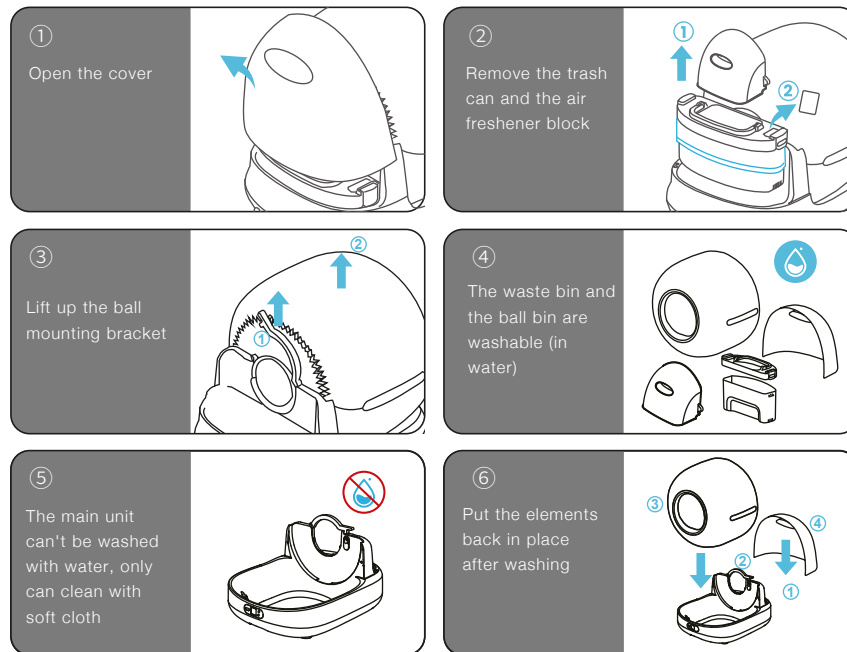









#### Notice:

- ① Ball bin/waste bin including rear cover can be washable. the base can only be wiped with water.
- ② The deodorant can be used for 14 days, and in APP you can check the days it can be used.



## VII. FAULT SELF-CHECK METHOD

Icon	Reason	Solution
	WiFi icon flashing, WiFi not connected	Press  to select the  icon, then press and hold  for 5 seconds. The WiFi icon will flash, and you can begin the app connection.
	When pet enters or during the process of adding & Emptying litter, this status will be displayed.	After adding or emptying litter, you can refer to the "Weight Calibration" instructions for recalibration, or wait 5 minutes for the device to automatically calibrate.
	Pet nearby/ Object blocking	Please check if the infrared sensor is blocked by a pet or an object. Remove any obstructing items.
	Waste bin full	The trash bin is full and needs to be replaced with a new garbage bag.
	Rear protective cover not properly secured	Please check if the rear cover is aligned properly with the grooves on both sides.

## VIII. FAQ

Q: Why does the APP's weight data not match my cat's weight?

A: Please check if it is caused by your pet's curiosity to access the device with just two feet; or pouring new cat litter or moving the cat litter, causing the weight to deviate.

Q: Why does the product indicate "Waste Bin Full  " when there is still space in the bin?

A: Check if there are any objects in the waste bin causing the top to rise, which may extend beyond the infrared sensor line.

Q: Why doesn't the product work after changing the litter bag?

A: When replacing the trash bag, if the bag extends beyond the infrared sensor, the sensor may be obstructed. Ensure the bag is arranged neatly and within the sensor's range.

Q: Why is the pet weight inaccurate?

A: After adding new cat litter, use the mode switch icon to select the weight calibration icon, then press the OK button briefly to recalibrate the weight.  
(Any movement, litter emptying, or litter replacement can cause weight discrepancies, all of which can be recalibrated.)

Q: Why does the screen display "Pet Entered  " after changing or adding cat litter?

A: Because the weighing module senses that there is cat litter or pets access to the ball bin: Because the weighing module can sense that there is an object to access, if it is to add cat litter, You can calibrate the device using the "Weight Calibration  " mode, or simply wait for 5 minutes for the product to calibrate automatically. If pets go to enter, it can be done without a hitch;

Q: Why doesn't it stop working immediately when a pet enters to Cat toilet ball ?

A: The weight sensors will take 1-2seconds to judge. Don't worry,the device is design in safty evaluations which to avoid pinching the cat . Hence, there is no risk if pet goes into ball and delay stop in 1-2 seconds;

Q: Why is the cat litter not completely cleaned during the cat litter pouring operation?

A: Due to the multi-layers of cat litter being put in ball bin, as per our experiment, it is suggest to operate the sand pouring 2-times and it will be completely clean up.

Q: Why can't I upload my cat's weight as soon as my pet enters the cat litter box?

A: No, because when the pet enters the ball bin, the weight sensors detected has not yet stabilized, and the datas can only be uploaded after the weight has stabilized, it will take around 10seconds for the device system to judge and datas message push to app.

## IX. PRODUCT SPECIFICATIONS

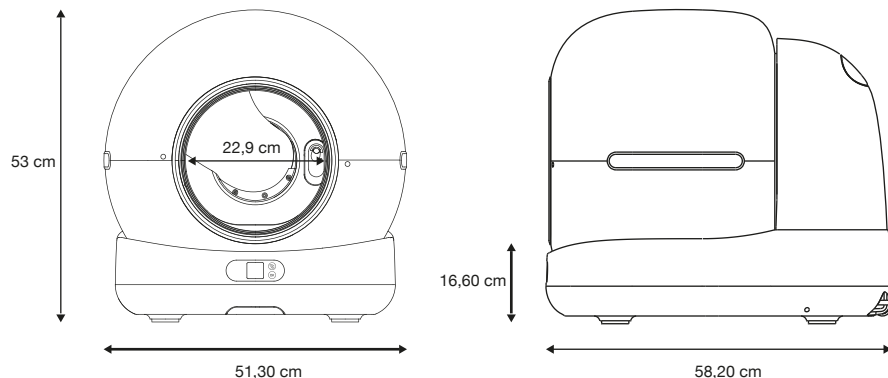

Barel capacity: 72L - Poop collection space: 7L  
Cat litter sands max.: 2,5Kg  
Cat litter size: have to be smaller than 10mm (length) and 3mm (diameter)  
Cat litter type: Tofu litter, Mix litter, Bentonite litter, Mineral litter  
Compatibility: cats from 1Kg minimum to 12Kg maximum  
Connectivity: Wifi 802.11b/g/n 2.4Ghz/5Ghz (wpa-2)  
Built-in camera: 1080P (2MP), wide angle, microphone for audio, night vision  
Smart video working: Snapshot, video recording, motion detection, one-way audio  
LCD display and touch button for basic operations  
Security: 4 weight sensors + 1 motion sensor  
Smartlife or Tuya application for litter controls, notifications, statistics, cat weighing, etc.  
Noise level: max 45dB  
Rated power:  $\leq 24W$   
Power adapter included: DC12V - 2.0A  
Wireless frequency : 2400 to 2483,5MHz - Max EIRP: 14,79dBm  
Product net weight: 8,8Kg

## X. DISPOSAL OF ELECTRICAL & ELECTRONIC EQUIPMENT



This symbol on the product or on its packaging indicates that this product shall not be treated as household waste. Instead it should be taken to an applicable collection point for the recycling of electrical and electronic equipment. For more information please contact your local council or waste disposal service.

## XI. ABOUT THIS MANUAL

We strive to ensure that the information contained in this manual are as accurate as possible. Changes may be made to the manual or the product without prior notice. The latest updates will be available on our website [www.pawzz.eu](http://www.pawzz.eu).

Our company shall under no circumstances be held liable for injury or damage caused by errors or omissions in this manual.

©Pawzz 2025. All rights reserved. All brands and trademarks mentioned in this manual are the property of their respective owners.

For questions about this product, please email us at [info@a6europe.com](mailto:info@a6europe.com).

## XII. EU DECLARATION OF CONFORMITY

We, A6 Europe s.a., established 127-129 rue Colonel Bourg, 1140 Brussels, Belgium, declare under our own responsibility that the following equipment :  
Brand : Pawzz - Item code : PA\_CLB100WT  
Product description : Automatic cat litter box

Complies to the essential provisions of the following EC Directive(s):

RED Directive: 2014/53/EU

LVD Directive: 2014/35/EU

EMC Directive: 2014/30/EU

RoHS Directive: 2011/65/EU, amendment 2015/863/EU

EU Directive 2009/125/EC, regulation (EU) 2019/1782

and respects the essential requirements of harmonized European standards:

EMC: ETSI EN301 489-1 V2.2.3: 2019-11

ETSI EN301 489-17 V3.3.1: 2024-09

EN55035:2017+A11:2020

EN55032:2015+A11:2020+A1:2020

EN IEC61000-3-2:2019+A2:2024

EN61000-3-3:2013+A2:2021

EN IEC 55014-1:2021 - EN IEC 55014-2:2021

Radio: ETSI EN300 328 V2.2.2: 2019-07

ETSI EN300 328 V2.2.1: 2024-11

Safety: EN IEC 61558-1:2019

EN IEC 61558-2-16:2009/A1:2013

EN IEC 60335-1:2020

EN IEC 60335-1:2012/A15:2021

Health: EN50665:2017

Energy Efficiency: EN 50563:2011/A1:2013

Cybersecurity: EN18031-1:2024 EN18031-2:2024

Date : August 2025

David Peroo, Product Manager

